



ENVIROCAN PTY LTD

PRODUCT DATA SHEET

PRODUCT DESCRIPTION

Sleek330ml (202/204)

57/52x146mm - 330ml - Aluminium Beverage Can

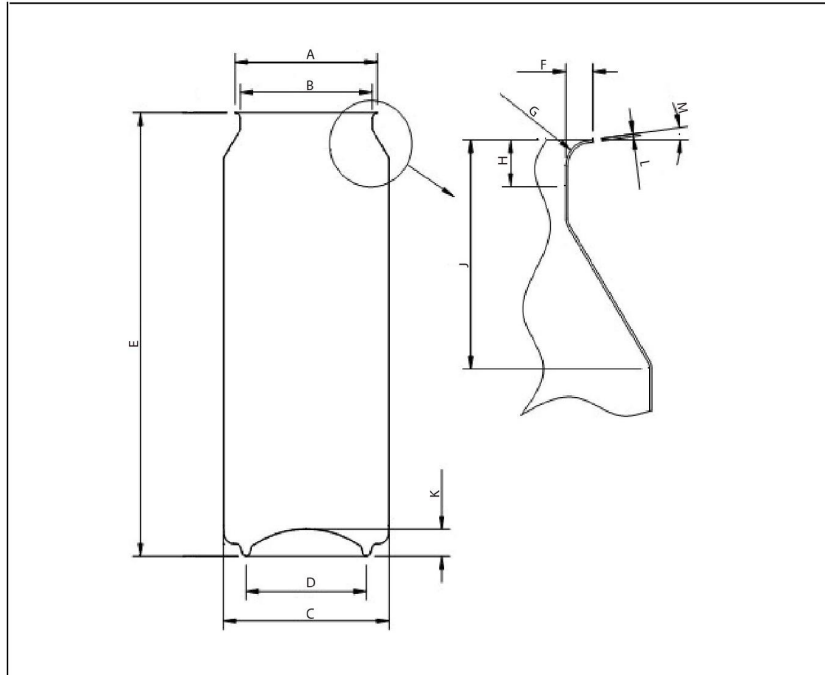

ENVIROCAN PTY LTD
ALUMINIUM CAN BODY SPECIFICATION

Status:
Issue Date:

All dimensions are in millimetres and are reference unless stated otherwise.

Material	Aluminium alloy
Temper	H19
Coil Thickness	0.280 ± 0.005mm

A Flange Diameter	57.5	MAX
B Plug Diameter	52.4	± 0,30
C Body Diameter	57.4	REF
D Base Diameter	46.23	REF
E Open Can Height	146.05	± 0,30
F Flange Width	2.08	± 0,25
G Flange Radius	1.524	REF
H Neck Seaming Clearance	3.0	MIN
J Shoulder Height	10.0	REF
K Dome Depth	10.37	
L Flange Thickness	0.16	
M Flange Angle	0-12°	

Brimful	357.6	ml
Axial Load	800	N MIN
Dome reversal	610	kPa MIN

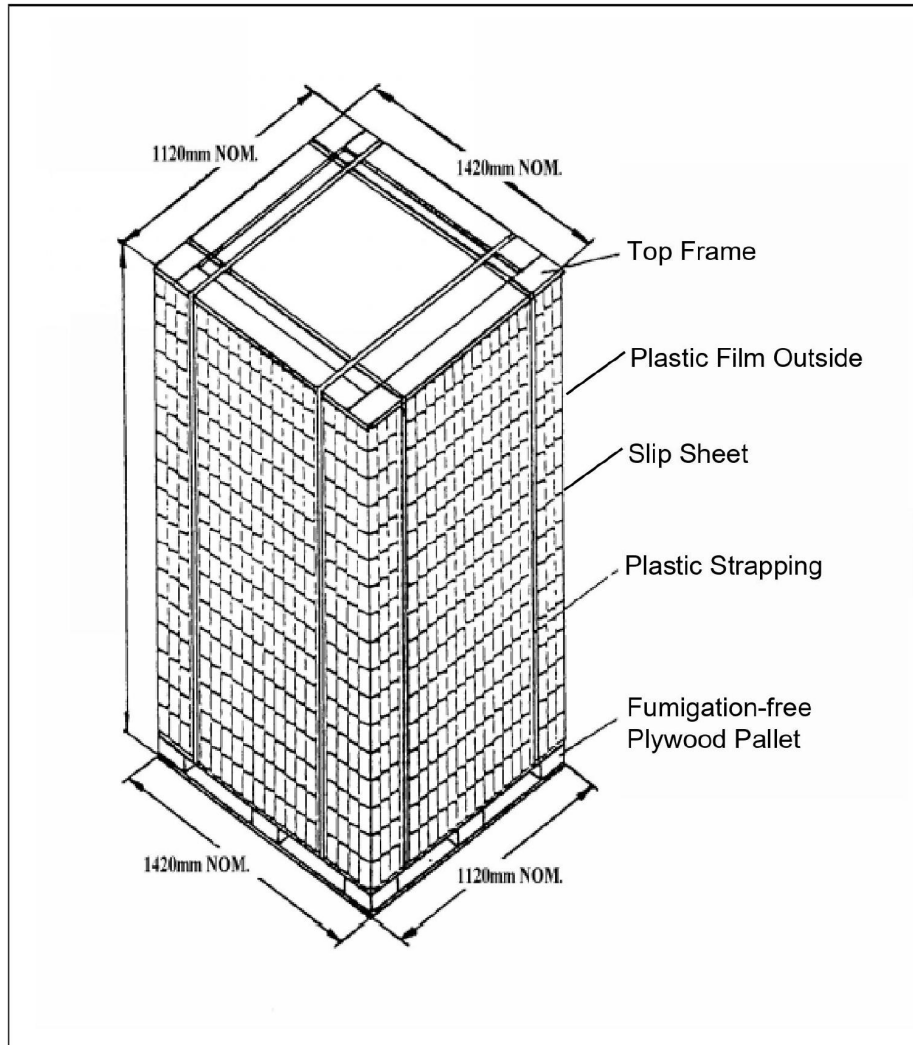

Sleek 330ML Aluminum Cans Packaging Specification

The packaging of the cans must be on a pallet with 389 cans, separated with a slip sheet, fumigation-free plywood pallet, frame on top, wrapped with plastic film and secured with plastic strapping. See attached image.

16 Levels
517 Cans per Level
8272 Cans per pallet
16 Pallets per 40HQ Container

Fumigation-free plywood pallet size:
W1120mm*L1420mm*H2466mm

Net Weight: 92kg REF
Gross Weight: 127kg REF